

BREL motors is part of:

BREL nederland b.v.

Manual Brel 35mm en 45mm electronic radio motor (alsof or zipscreen)

Type MEV35 + MEV45

Read the manual before you begin the installation. If these instructions are not followed, this may lead to defects and injury in which warranty can't be claimed.

warning:

Children cannot recognize the dangers of electrical equipment and may therefore not work with it.

It is important to follow this instruction for your own safety.

1. Do not operate the motor in humid surroundings.
2. The motor must be installed correctly.
3. Keep the antenna in a good condition and do not shorten. The antenna should not come into contact with other metal parts otherwise it will reduce the effect.
4. The motor must be protected from direct moisture influences.
5. The motor should be installed with the motor cable down in order to prevent moisture via the motor cable is running in the motor . See Figure 1
6. It is prohibited to connect two motors on a switch without using a relay control.

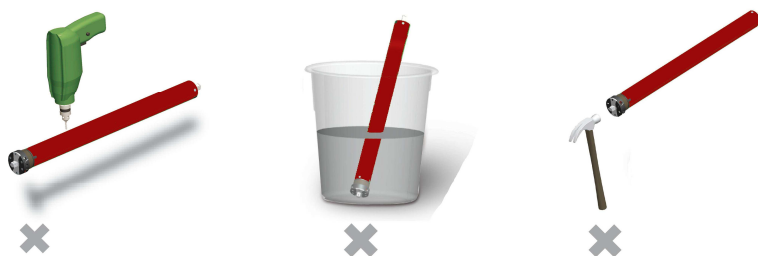
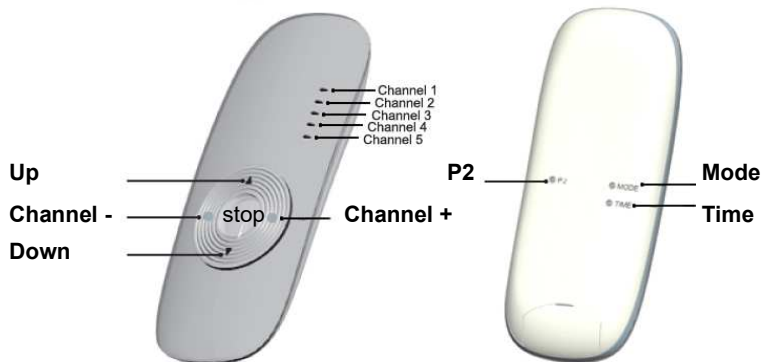
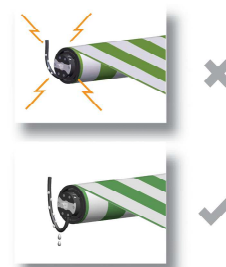

Figure 1



If in the 5 channel transmitter all the lights are burning, All the products are operated simultaneously. (mode and time have only a function on an emitter with a timer)

Technical data of the motor:

	Type MEV35-0.6	Type MEV35-10	Type MEV45-20	Type MEV45-30	Type MEV45-40
• Motor Voltage:	AC 230V	AC 230V	AC 230V	AC 230V	AC 230V
• Power:	144 Watt	144 Watt	145 Watt	198 Watt	228 Watt
• Torque:	6Nm	10Nm	20Nm	30Nm	40Nm
• Speed:	28rpm	17rpm	15rpm	15rpm	15rpm
• Ampèrage:	0.62A	0.62A	0.64A	0.86A	0.99A
• Moist and dust:	IP44	IP44	IP44	IP44	IP44
• Storage capacity is up to 20 channels					
• Temperature of the motor:					
○ Normal use:	-10°C tot +40°C				
○ Heavy use:	-20°C tot +70°C				



Functions

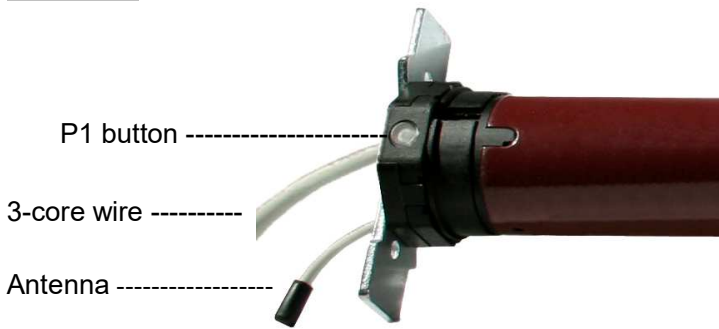

Reach

L1 = 100 meter

L2 = 25 meter

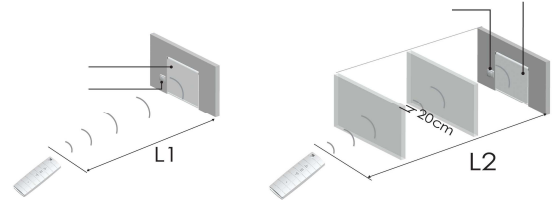

Installing the motor

Attach the crown and wheel to the motor and place the clip on the shaft of the motor so that the wheel is fixed to the motor.

Install the motor with the motorbracket on the product and take care that it is secured.

Place the motor in the tube of the roller/shutter.

(These assemblies are usually already done in the factory)

During programming the motor the following must be done within 10sec.
After 10 sec. the motor will quit the programming mode.



EMERGENCY CONTROL: If a channel is connected to the motor, you can use the P1 key as control key.

Step 1 Setting up the first channel

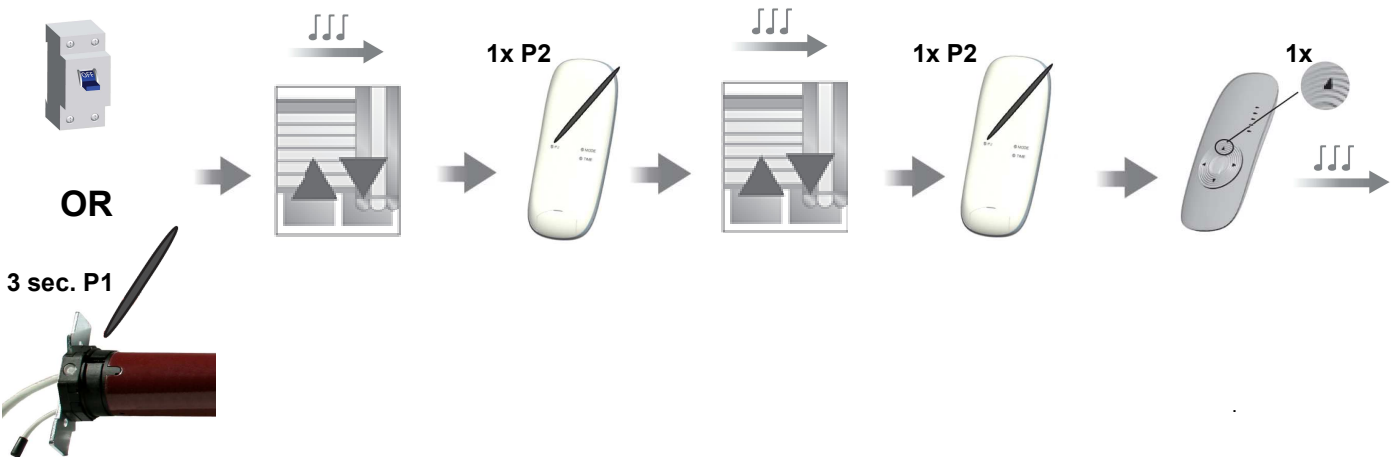

Apply power to the motor. The product moves up and down and beeps 3x.

OR

Press the P1 button for 3 seconds the product moves up and down and beeps 1x.

Press 1x on the P2 button. The product moves up and down and beeps 1x.

Press again on the P2 button. The motor beeps 1x.

Press 1x on button up. The product moves up and down and beeps 6x.

With the above action you will delete all channels in memory and the final setting.

Step 2 Change direction If the direction is right , skip step 2 and proceed to step 3.

Option A

1x P1

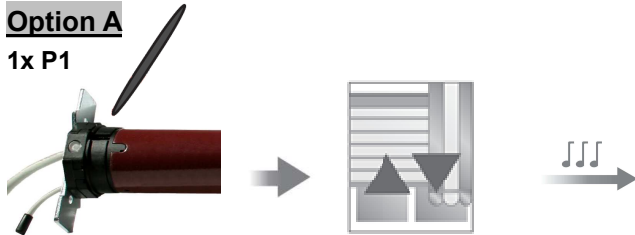

Hold P1 pressed until the product moves up and down for 2x. The motor beeps 2x to confirm.

Option B

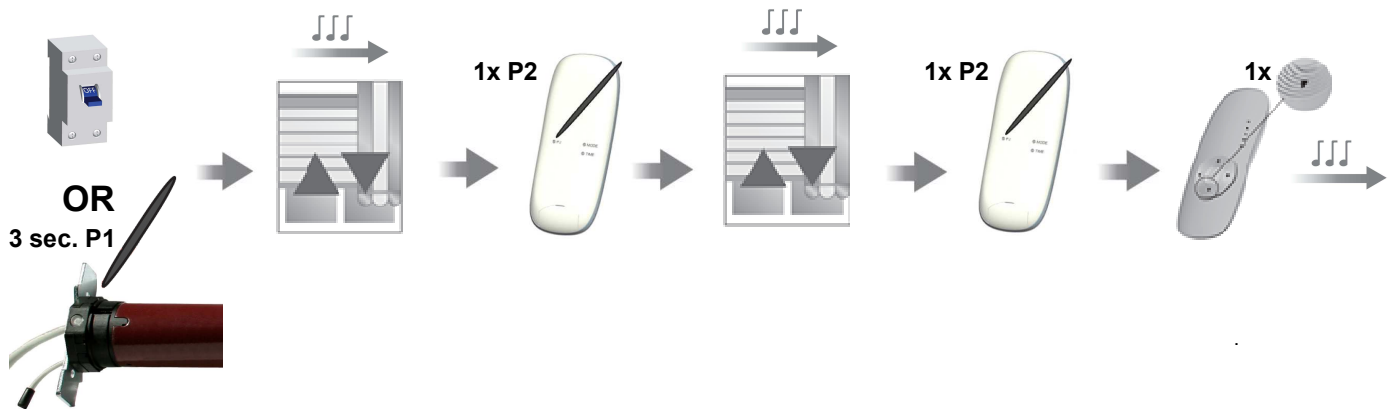

Apply power to the motor. The product moves up and down and beeps 3x.

OR

Press the P1 button for 3 seconds the product moves up and down and beeps 1x.

Press 1x on the P2 button. The product moves up and down and beeps 1x.

Press again on the P2 button. The motor beeps 1x.

Press 1x on button down. The product moves up and down and beeps 6x.

With the above action you will delete all channels in memory and the final setting.

Step 3 Obstacle reversing function

The operation of the obstacle reversing function has 4 modes.

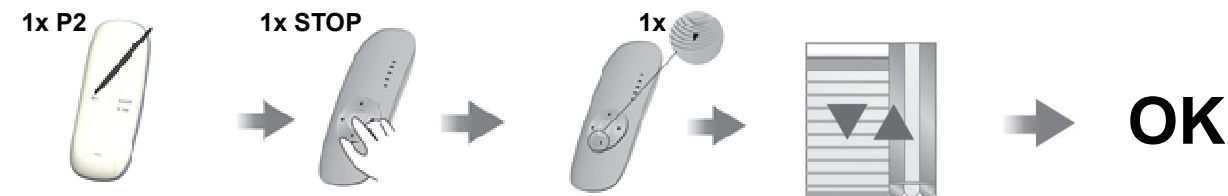

Press 1x the P2 button. The product moves up and down and beeps 1x.

Press the stop button 1x. The product moves up and down and beeps 1x.

Press the button down 1x.

- Mode 1:** the product moves 1x up and down
- Mode 2:** the product moves 2x up and down
- Mode 3:** the product moves 3x up and down
- Mode 4:** the product moves 4x up and down

MODE 1

No sensitive resistance and stop function.
About 20 cm.

The obstacle stop and reverse function.

Only the stop function works.
About 8 cm



MODE 2

No sensitive resistance and stop function.
About 4 cm.

The obstacle stop and reverse function.

Only the stop function works.
About 8 cm

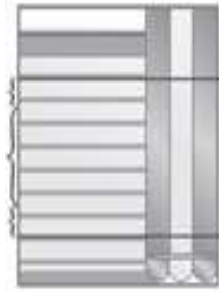

MODE 3

No sensitive resistance and stop function
About 4 cm.

The obstacle stop and reverse function.

Only the stop function works.
About 8 cm

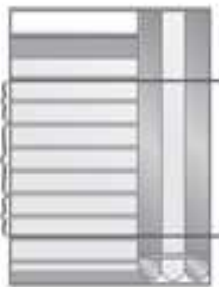

MODE 4

No sensitive resistance and stop function_



(In MODE 3, you need to set no upper position)

MODE 1 : Large shutters

MODE 2 : Small shutters

MODE 3 : Screens and rectangular awnings

MODE 4 : No obstacle detection

Upper set point to set it with remote control.

Upper set point to set it with remote control.

Upper set point is on the basis of mechanical resistance.

If you switch MODE, you must set the end position.

Step 4 Setting the end limits

1x P2



Press 1x the P2 button.
The product moves up and down and beeps 1x.



1x



Press 1x the button up.
The product moves up and down and beeps 1x.



1x P2



Press 1x the P2 button.
The product moves up and down and beeps 1x.



1x

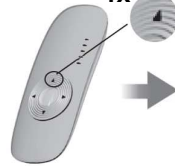

Place the product on the desired top position.
(Not applicable to MODE 3)

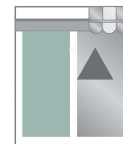

5x STOP



Press 5x on the stop button, until
The product moves up and down.
(Not applicable to MODE 3)



1x

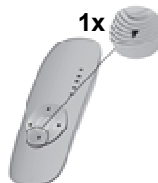

Set the product on the end position.



5x STOP



Press 5x on the stop button, until
The product moves up and down.
(After this for MODE 3 press up)



Step 5 Setting third limit position

If you press the stop button for more than 3 seconds, the motor will move from any position to the third limit position.



To remove the third limit position, you must go to the third position and repeat above action.

Additional settings

Option A Delete limit position

With the procedure; Teach 1^e transmitter, the final positions will also be deleted.

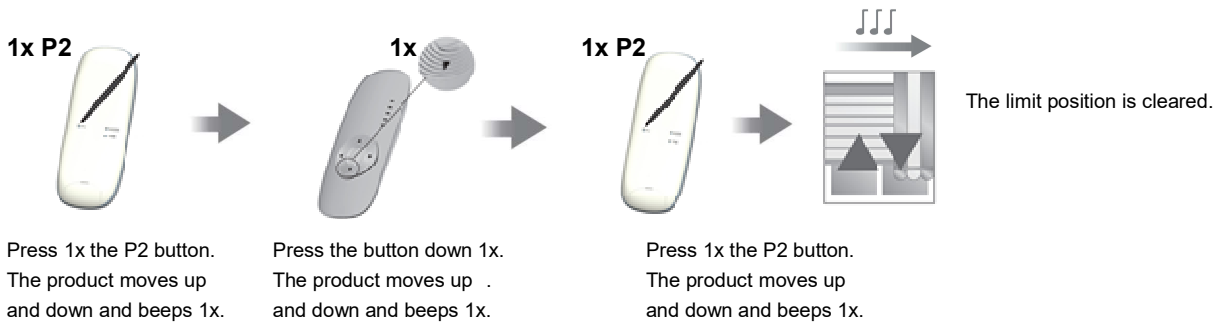

Option B Teaching multiple transmitters (Up to 20 transmitters per receiver)

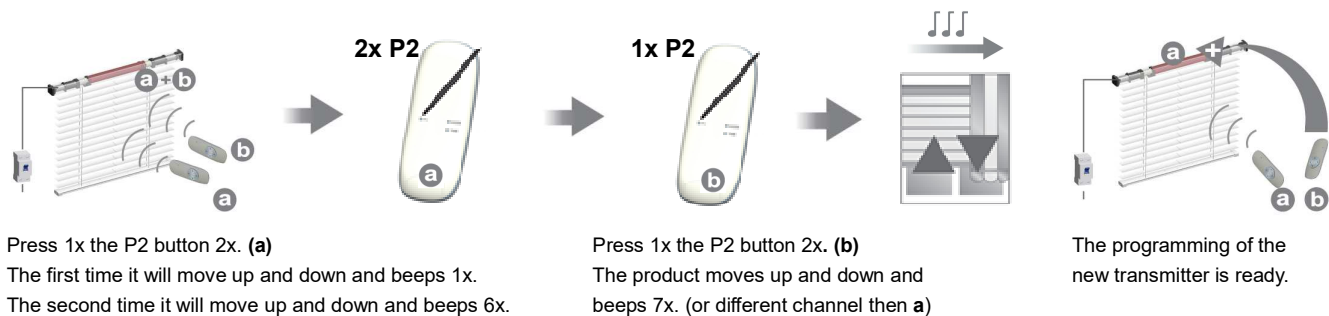

To delete one channel, you must repeat the above operation.

Option C Reset all

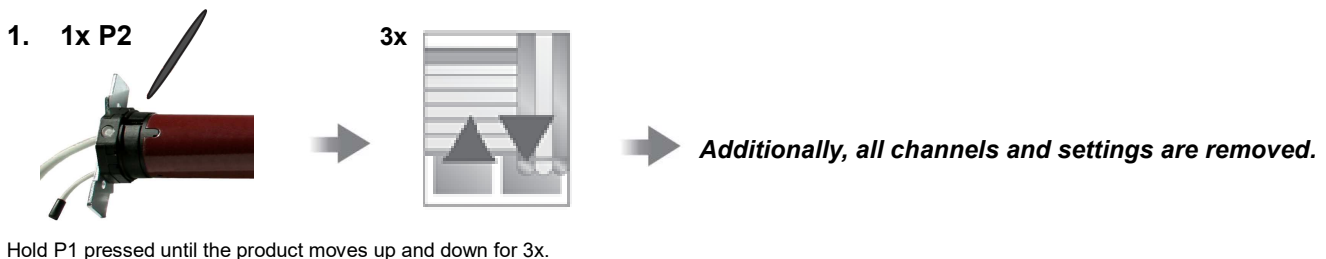

2.

1x P2



Press P2 button 1x.
The product moves up
and down and beeps 1x.

1x STOP



Press the stop button 1x.
The product moves up
and down and beeps 1x.

1x P2



Press P2 button 1x.
The product moves up
and down and beeps 1x.

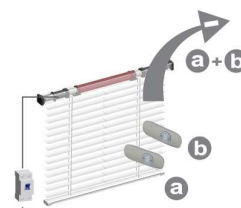

All channels are removed

Option D Puls setting

1x P2



Press P2 button 1x.
The product moves up
and down and beeps 1x.

1x



Press the button up 1x.
The product moves up
and down and beeps 1x.

1x



Press the button down 1x.
The product moves up
and down and beeps 2x.



The motor is ready for use.

To remove the pulse setting, repeat the above operation.