

BREL motors is part of:

**BREL nederland b.v.**

**Manual Brel external receiver**

**Type DC-101**

Read the manual before you begin the installation. If these instructions are not followed, this may lead to defects and injury in which warranty can't be claimed.

**Technical data of the receiver**

**Type DC-50**

- Voltage:
- Power output:
- Radio frequency:
- Moisture and dust resistance:
- Temperature range of the motor:

230V 50Hz

800W

433.92MHz

IP55

- Normal use: -10°C to +40°C

- Heavy use : -20°C to +70°C



**Button specification**

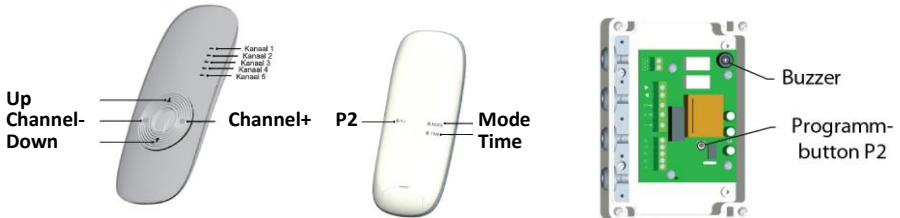

**Works with these BREL motors and receivers:**

**Motors:** MR, MEV, MCE, MDE, MLE, MJE, MTE, MEQ, MPE.

**Receivers:** DC-50, DC-90, DC-92, DC-94, DC-101, DC-109, DC-114, DC-227, DC-252, DC-253, DC-292, DC-305, DC-306, DC-2702.

**Installation of the receiver**

**Reach**

L1 = 200 meter L2 = 35 meter



DC-101 single receiver

- X Wireless receiver
- X Electronic
- X Light-touch
- X Dot-move
- X Connect 20 unit emitters at most
- X Standard type DC-101 can store 20 effective channels

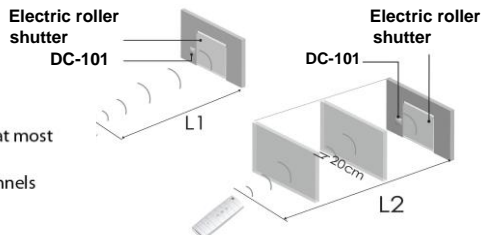

**Wiring diagram**

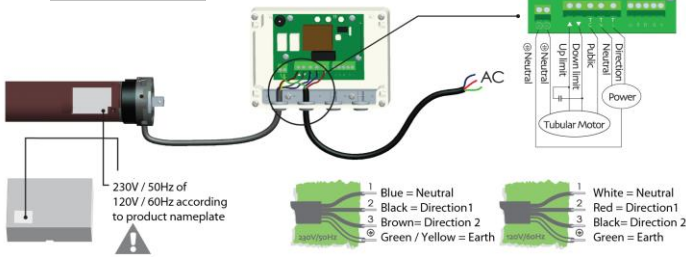

**Best Distance**

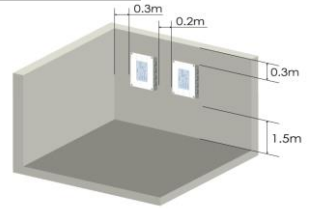

- 1 The shortest distance between receiver and ground > 1.5m
- 2 The shortest distance between receiver and ground > 0.3m
- 3 The shortest distance between receiver and ground > 0.2m

**Reading multiple transmitters in the memory of the motor**

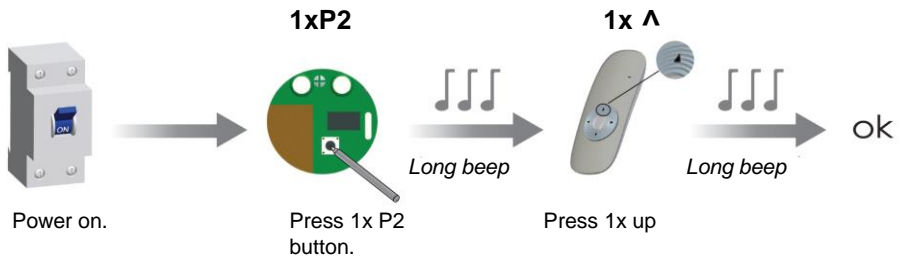

**To remove a transmitter, repeat the above.**

**Delete all channels**

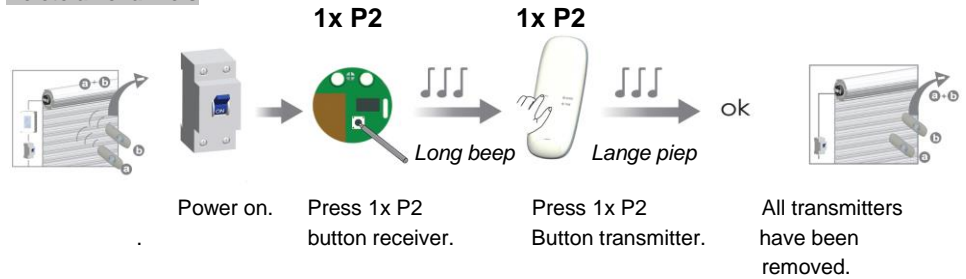

**Setting the pulse control**

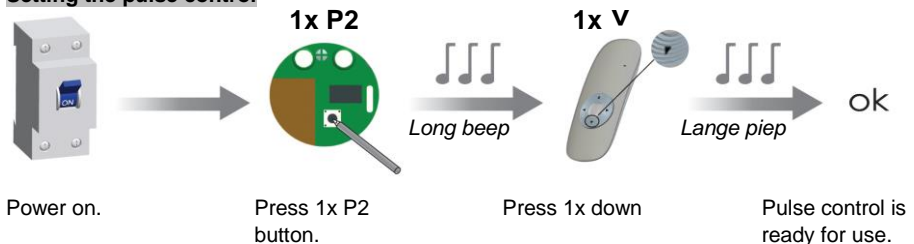

**To remove the pulse control, repeat the above procedure.**